

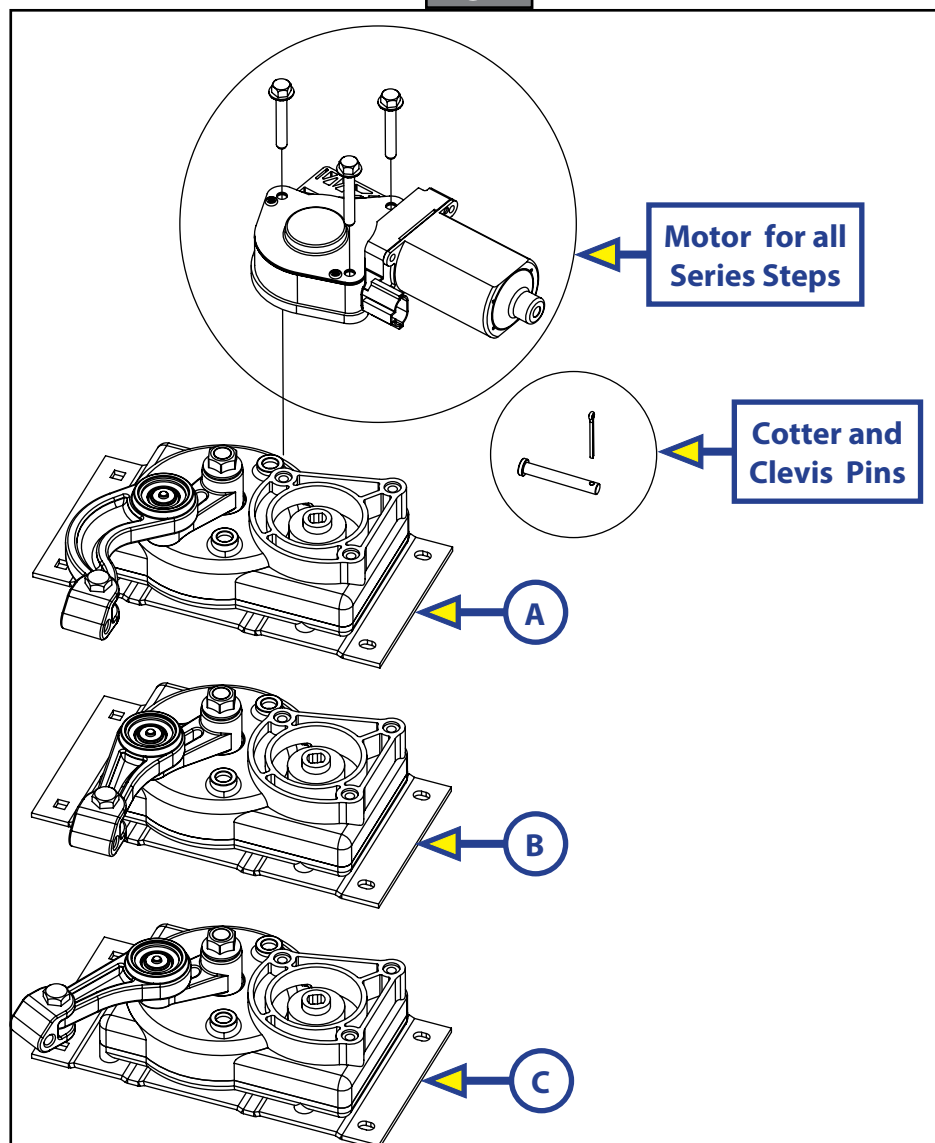

## Electric Step Improvements

This reference applies to the following Kwikiee® Electric Series Steps: 22, 23, 24, 25, 26, 28, 30, 31, 32, 33, 34, 35, 36, 37, 38, 39, 40, 42 and 44. Part Number 909770000 (Kwikiee®) or [379145](#) (LCI®) Linkage A; applies to the following Series Steps: 22, 23, 30, 32, 33, 34, 35, 36, 38 and 40. Part Number 909772000 (Kwikiee®) or [379769](#) (LCI®) Linkage B; applies to the following Series Steps: 28, 31, 37 and 39. Part Number 909774000 (Kwikiee®) or [379801](#) (LCI®) Linkage C; applies to 26 Series Steps.

**Fig. 1**



The Replacement Kits contain an IMGL (Integrated Motor/Gearbox/Linkage Assembly), a control unit, a 4-way pigtail, and a fastener kit. Replacing the motor, gearbox, and linkage with the IMGL on a step **that has any other controller than a 909510000 (Kwikie®) or 379146 (LCI®) Control Unit** (as included), requires the installation of the new control unit Part Number 909510000 (Kwikie®) or Part Number 379146 (LCI®) included in the replacement kit. The step improvements were made to increase performance, reliability and the longevity of step operation. The changes also simplify the parts procedure.

### Improved Linkage and Gearbox

An investment cast, zinc plated steel linkage assembly, is stronger and more resistant to corrosion. There is now a brass spherical outer cage, with a hardened ball linkage, which is stronger and has increased longevity. This change also allows for greater resistance in the tendency for the linkage to oblong. An improved gearbox has also been fully sealed, with a dual ball bearing for greater efficiency and no maintenance. Gearbox case halves are now sealed for consistent alignment and greater weather resistance.

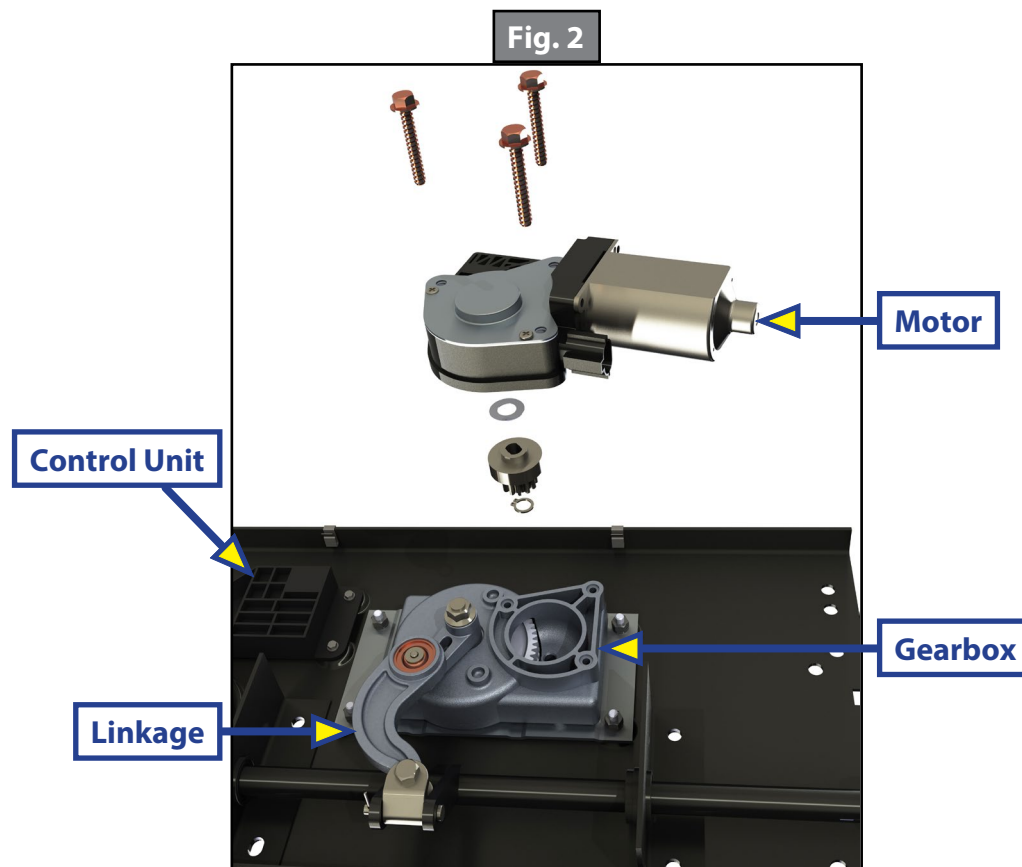



### Improved Motor

The new step motor now has 40% more torque, which gives the step assembly a stronger lock-out and solid feel.

### Improved Control Unit Logic

The step is controlled by a new control unit. This controller now defaults to an always open status, when the door is open. The step assembly can now be locked into the open and extended position. The step assembly cannot be locked into the closed and retracted position. An automatic ignition override feature makes the step assembly follow the action of the exterior door.

### **New Owners Manual**

A new **#888 Owners Manual** now ships with all Series Steps that have the improved step assembly components, except for the 42 and 44 Series Steps. A new **#842A Owners Manual** ships with the 42 Series Step and a revised owners manual ships with the 44 Series Steps.

One of the new important changes covered in the new owners manual is the **"Override Switch"** (previously called the "Power Switch" in the old owners manual). The name of the switch changed because of a change in functionality from the former "Power Switch".

The new control units are equipped with an ignition override system, designed to prevent the vehicle from being driven with the step assembly in the extended and open position. When the step is locked in the extended position (**OVERRIDE SWITCH IS IN THE 'ON' POSITION**), the door is closed and the ignition is in the "ON" position; the ignition override system will engage and the step will automatically retract. This prevents damage to both the step assembly and vehicle.

**This is a change from the old "Power Switch", which needed to be in the "OFF" position to lock the step out. Call Lippert Components, Inc. Customer Service at 1-574-537-8900 with further questions.**