



Purpose

Bracket Placement

The purpose of this Quick Reference (QR) is to identify landing gear stop tabs, and to show the different landing gear installation options available. The landing gear stop tabs prevent the landing gear from slipping through the landing gear bracket. This document applies to the landing gear bracket PN [113511](#), and all included hardware.

Landing Gear Bracket Inside Configuration

Landing Gear Bracket Outside Configuration

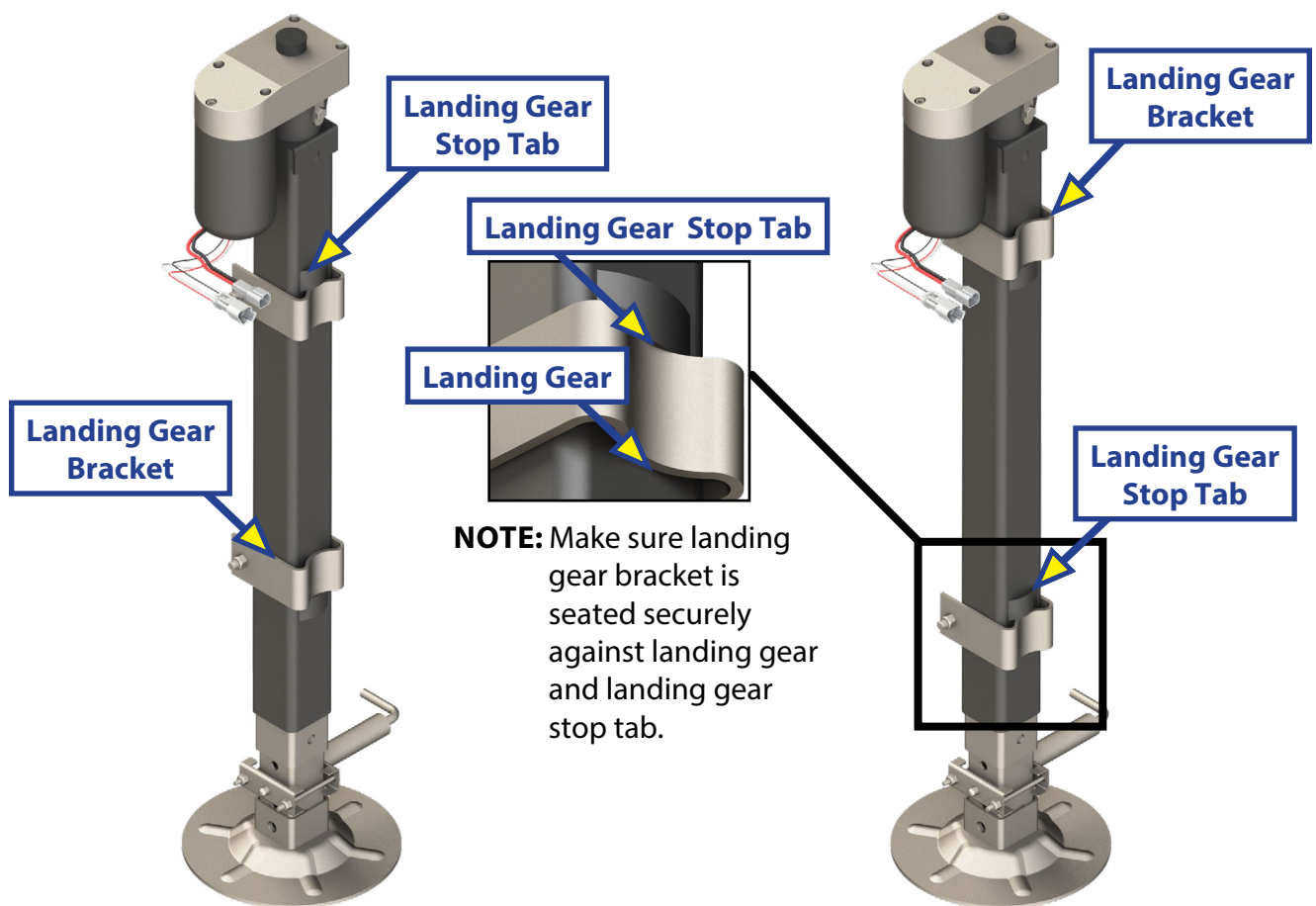

Securing Bracket

After the bracket is seated correctly, the nut can be tightened. Tighten the landing gear bracket nut (A) to 10-18 ft-lbs. The landing gear bracket flanges should not measure less than 2 3/8" on the inside diameter.

NOTE: Bolt is not used as a stop.

