



LIPPERT
COMPONENTS®

Formerly  Atwood Mobile Products

LITERATURE NUMBER **MPD 87297**

LATCH REPLACEMENT

ENGLISH

•Installation •Operation •Maintenance

Effective 12/4/07

2" Yoke Style Coupler

2-5/16" Yoke Style Coupler

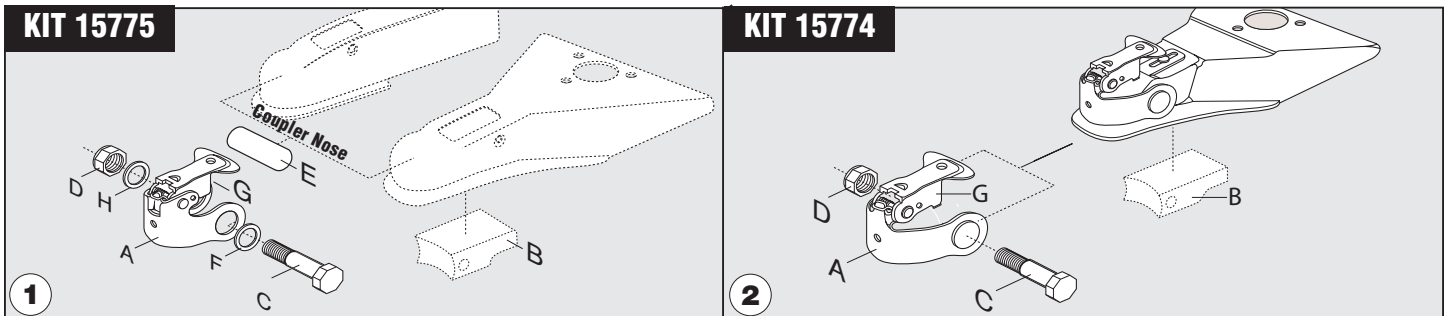

For complete coupler instructions consult MPD 87984.



WARNING

PERSONAL INJURY/PRODUCT DAMAGE

- Replace couplers that are worn or damaged, or not operating freely.



WARNING

PRODUCT DAMAGE

- Coupler must be disengaged from hitch ball.
- Latch must be in closed position for repairs.

TO TAKE APART

1. Grind off staked end of pin (FIG 1 & 2-C) that goes through nose of coupler.
2. Slide pin out side of coupler.
3. Remove ball clamp (FIG 1 & 2-B) from under side of coupler nose.
4. Remove latch and yoke assembly from top of coupler nose.
5. Discard old parts. **DO NOT REUSE!**

INSTALLATION PROCEDURE

1. Place latch and yoke assembly (FIG 1 & 2) over coupler nose and align holes on yoke assembly with holes on sides of coupler nose and hold in place.
2. Place ball clamp (FIG 1-B & 2-B) inside nose of coupler and align its holes with holes in yoke assembly and holes in sides of coupler nose.
3. **For 2" coupler -**
 - a. Place insert sleeve (FIG 1-E) into ball clamp (FIG 1-B) and install under coupler nose.
 - b. Place washer (FIG 1-F) on bolt (FIG 1-C).
 - c. Align the hole in the latch yoke assembly (FIG 1 A) and insert sleeve/ball clamp assembly (FIG 1 B & E) with the hole in the coupler nose. Install bolt assembly (FIG 1 C & F) through both sides of coupler nose.
 - d. Place other washer (FIG 1-H) and nut (FIG 1-D) on exposed threaded portion of bolt and torque nut to 15 ft. lbs.
3. **For 2-5/16" coupler -**
 - a. Place ball clamp (FIG 2-B) under coupler nose.
 - b. Align the hole in the latch and yoke assembly (FIG 2-A & G) and ball clamp (FIG 2-B) with the hole in the coupler nose. Install the hole in the coupler nose followed by the bolt (FIG 2-C).
4. Check coupler for proper latching on a proper diameter ball. Insert ball, close coupler. The two legs of the latch handle (FIG 1 & 2-G) **MUST** fit snugly into the mating 2 slots on top of the coupler.