



## Description

Externally mounted cellular antenna assembly for use in North American market. Designed for rooftop, cabin, worksite, etc. mounting, maximizing reception range and power by avoiding signal interference. LTE Diversity Antenna design reduces interference from radio transmission, assuring optimum reception signal strength at all times.

Will withstand rain/snow and other adverse weather conditions. UV resistant plastic. Low profile reduces rooftop interference when mounted to a vehicle.

Mates with SMA RG-174 coaxial cable. Option for bulkhead SMA female connector. Compatible with LCI WiFi On-The-Go™ and OneControl® ConnectAnywhere™ systems.

## Applies to:

LCI Part #	Description
722255	External mount cellular antenna

## Key Features

- North-American 4G/3G (LTE / GSM / HSPA / WCDMA /UMTS / Wi-Fi)
- External rooftop mount for maximum reception range and power
- LTE diversity antenna
- Planar Omni-directional pattern
- Low-profile weatherproof installation
- Works with WiFi On-The-Go™ and ConnectAnywhere™ systems

## Specifications

Frequency Range	690-960 MHz 1810-2700 MHz
Frequency Band (North American)	4G: LTE / Wi-Fi 3G: GSM / HSPA / WCDMA / UMTS
Antenna Gain	690-960 MHz: 2.0 dBi 1810-2700 MHz: 3.0 dBi
Antenna Port Impedance	50 Ω, VSWR = 1:2.0
Connector options	RG-174 with SMA Male Bulkhead SMA Female
LTE Diversity	Spatial Separation Orthogonal Orientation Optimized Isolation
Field Pattern	Planar Omni-Directional Pattern Vertical Polarization
Operating Temperature	-40°C to +85°C
IP Rating	Designed to IP 65 (under test)
Humidity	Non-Condensing 65 °C, 95% RH



LIPPERT  
COMPONENTS

# EXTERNAL MOUNT CELLULAR ANTENNA

S-003

## ELECTRONICS

### Mechanical Characteristics

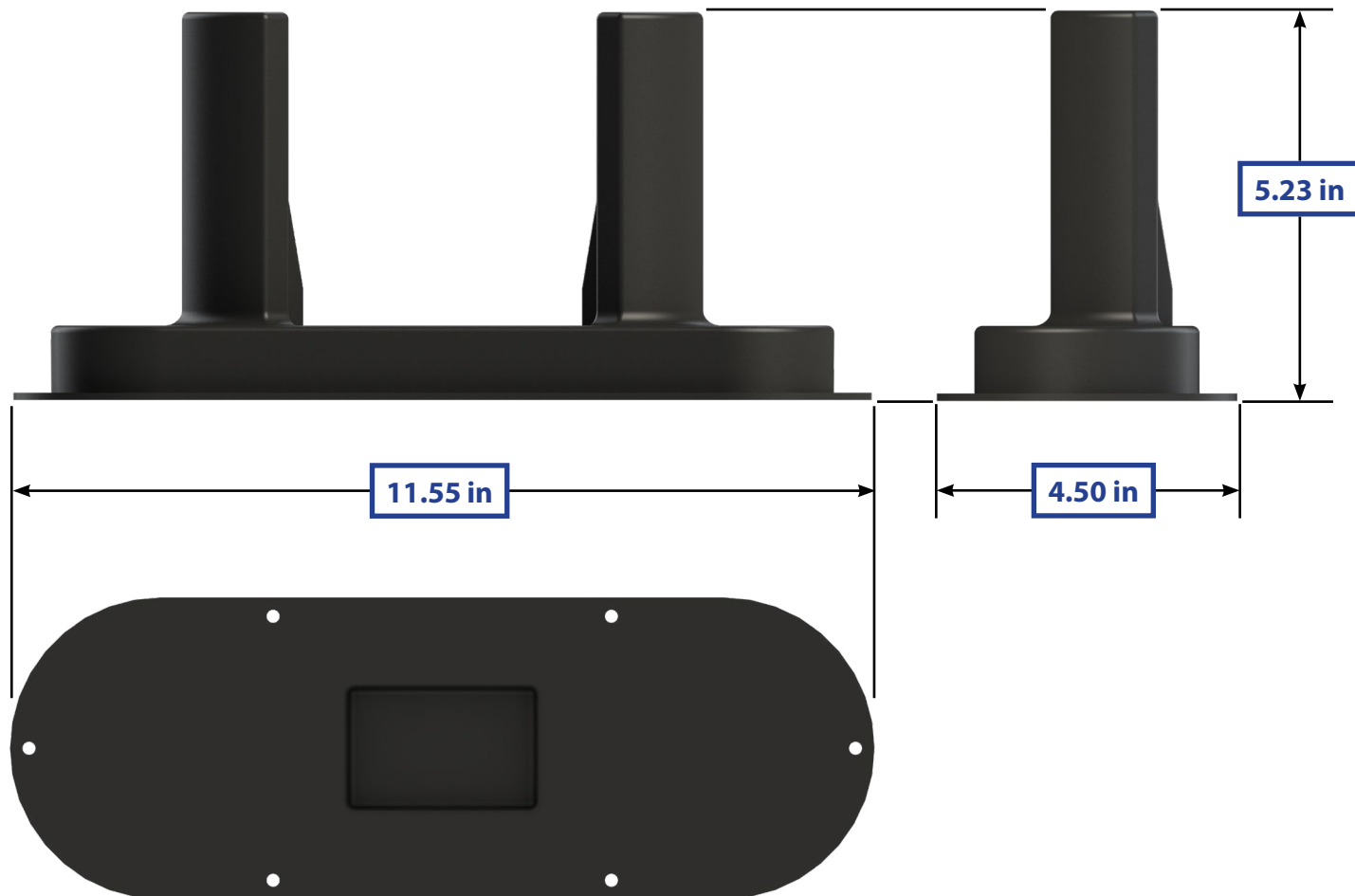

As a supplier of components to the RV industry, safety, education and customer satisfaction are our primary concerns. Should you have any questions, please do not hesitate to contact us at (574) 537-8900 or by email at [customerservice@lci1.com](mailto:customerservice@lci1.com). Self-help tips, technical documents, product videos and a training class schedule are available at [lci1.com](http://lci1.com) or by downloading the MyLCI app.