

POWER AND MOTION

Programming the Extend and Retract Stops

1. To enter programming mode, hold the Configuration button (Fig. 1A) for five seconds.

NOTE: The green LED will flash, and the red LED will light up solid.

2. Set the extend limit by holding the UP button (Fig. 1B) on the remote (or EXTEND on the wall switch) and stopping at the desired height.
3. Press the Configuration button (Fig. 1A) to set the extend limit.

NOTE: The red LED will flash, and the green LED will light up solid or turn off.

4. Set the retract limit by holding the DOWN button (Fig. 1C) on the remote (or RETRACT on the wall switch) and stopping when the TV is fully lowered into the cabinet.
5. Press the Configuration button (Fig. 1A) to set the retract limit.

NOTE: Both LEDs will blink for 3 seconds and then the receiver will exit programming mode. The stops are now set.

NOTE: If the LEDs continue to flash, reprogram the stops by going through steps 2-5.

Syncing the Remote to Receiver

1. Push the Configuration button (Fig. 1A) on the receiver three times and hold on the third.
2. Green and red LEDs will flash back and forth (Fig. 1).
3. Push any button on remote (Fig. 1).
4. When the remote is synced, green and red LEDs will flash back and forth again and then shut off.

Operation

1. To raise the TV, press and hold the Up button (Fig. 1B) until the TV lift is fully raised into position.
2. Press the Down button (Fig. 1C) once and release to lower the TV. The TV lift will lower the TV into the cabinet with "One Touch" operation of the remote.

NOTE: When replacing a remote, the TV Lift kit ([253395](#) - Fig. 1) **MUST** be purchased as the remote is not sold separately.

NOTE: The original remote for this system (Fig. 2) is no longer available for use with this system.

Fig. 1 - [253395](#)

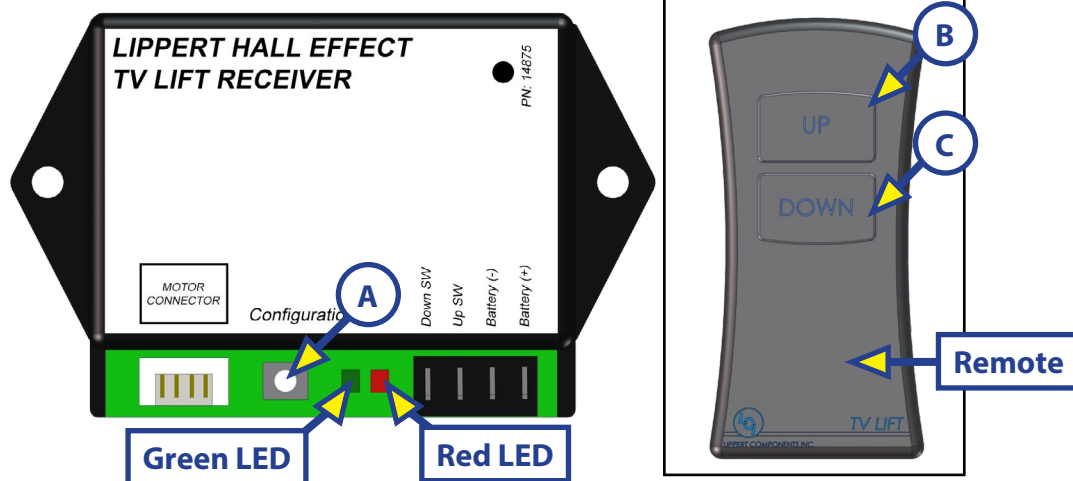

Fig. 2



As a supplier of components to the RV industry, safety, education and customer satisfaction are our primary concerns. Should you have any questions, please do not hesitate to contact us at (574) 537-8900 or by email at customerservice@lci1.com. Self-help tips, technical documents, product videos and a training class schedule are available at lci1.com or by downloading the MyLCI app.