

**SLIDE-OUTS**

A revision has been made to the Inner Tube Assembly on Through Frame Slide-outs. The Rear Roller ([104475](#)) and Roller Shaft ([105893](#)) have been removed and replaced with a Wear Tab ([277882](#)). These new Inner Tube Assemblies are 100% interchangeable with the former design. This change was made to reduce noise created by the Rear Roller. See the illustrations below. See Page 2 for a part number comparison chart between the old version and new version.

Old version with Rear Roller ([104475](#)), Roller Shaft ([105893](#)), and Inner Tube Assembly (See Page 2)

New version with Wear Tab ([277882](#)) and Inner Tube Assembly (See Page 2)

**Fig. 1**

Top View



**Fig. 2**

Front View

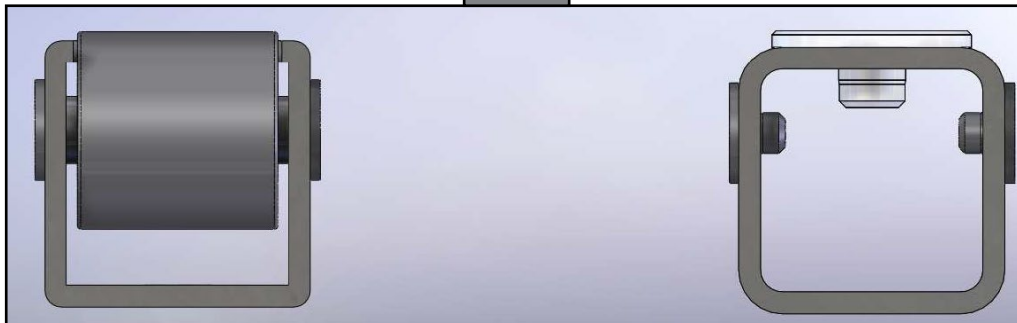

**Fig. 3**

Isometric View

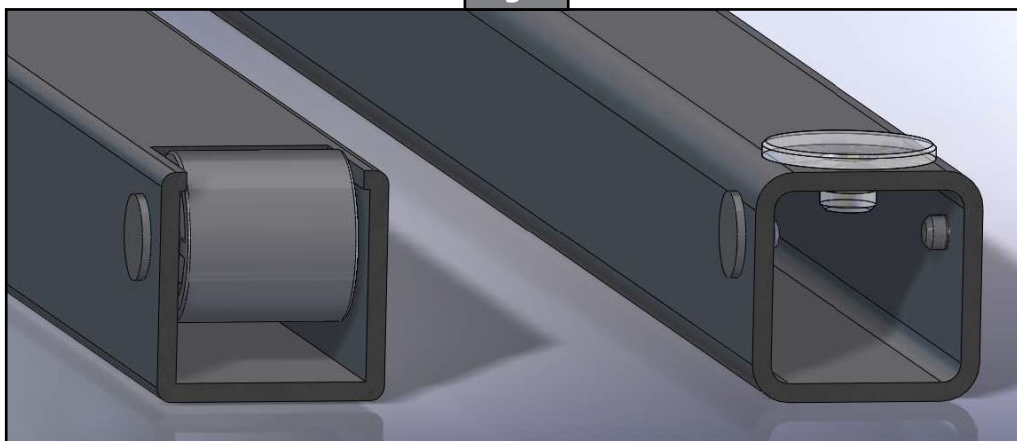



# INNER TUBE ASSEMBLY REVISION ON THROUGH FRAME SLIDE-OUTS

TI-184

## SLIDE-OUTS

Through Frame Slide Inner Tube Assemblies			
	Old Part Number w/ Rear Roller	New Part Number w/ Wear Tab	Description <i>(All dimensions noted below are in inches)</i>
Inner Tube Only	163778	301393	2 x 2 Inboard
	<a href="#">145736</a>	<a href="#">296090</a>	2 x 2 Outboard
	<a href="#">143710</a>	296121	2.5 x 2.5 Inboard
	<a href="#">143707</a>	306908	2.5 x 2.5 Outboard
Full Systems	159390	317317	2 x 2 Inboard System
	119150	317319	2.5 x 2.5 Inboard System
	119151	317321	2.5 x 2.5 Outboard System
Arm Assemblies		320413	2 x 2 x 72.75 O/B Arm Assembly
		320415	2.5 x 2.5 x 72.75 O/B Arm Assembly
		320419	2 x 2 x 70 I/B Arm Assembly
		320422	2.5 x 2.5 x 70 I/B Arm Assembly
		321279	2 x 2 x 78.75 O/B Arm Assembly

As a supplier of components to the RV industry, safety, education and customer satisfaction are our primary concerns. Should you have any questions, please do not hesitate to contact us at (574) 537-8900 or by email at [customerservice@lci1.com](mailto:customerservice@lci1.com). Self-help tips, technical documents, product videos and a training class schedule are available at [lci1.com](http://lci1.com) or by downloading the MyLCI app.